

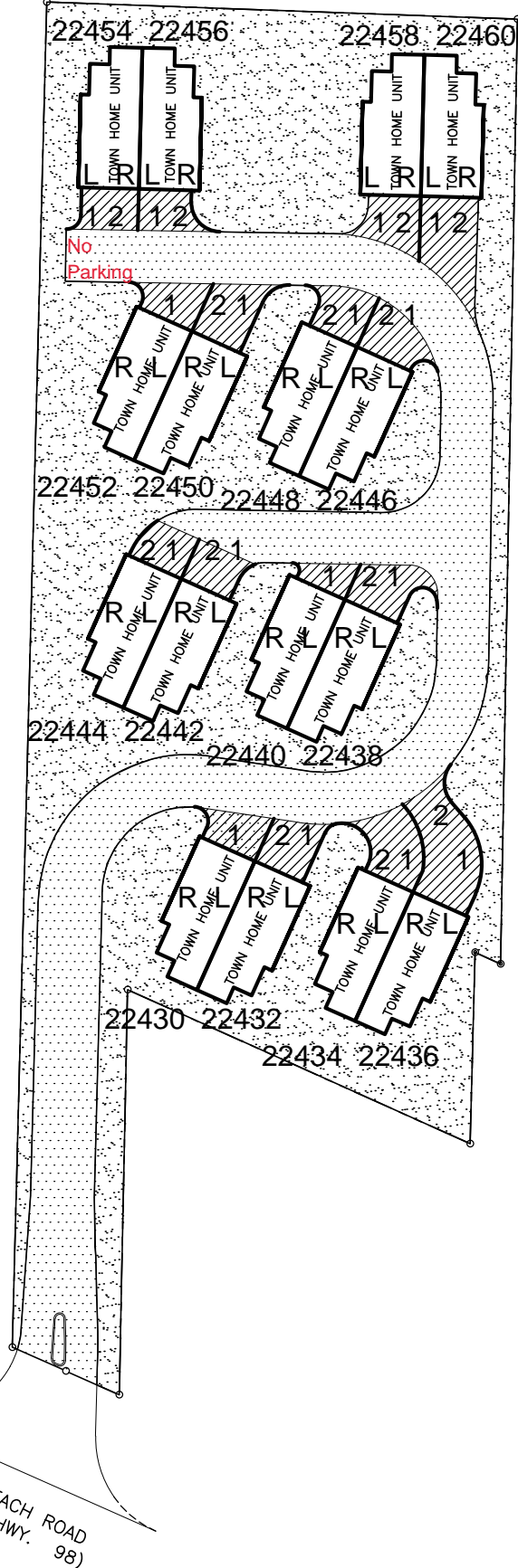

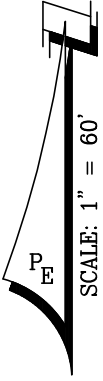

Date: Sep 30, 2015, 11:30am User ID: refFile: C:\Users\ref\REFPC\AppData\Local\Microsoft\Windows\Temporary Internet Files\Content.Outlook\SJM09K1Y\78101-CONDO-EXHIBIT.DWG



CASA DEL MAR PARKING PLAN

LEGEND

-  DENOTES TOWN HOME UNIT
-  DENOTES LIMITED COMMON AREA
-  DENOTES COMMON AREA

FRONT BEACH ROAD
(U.S. ALT. HWY. 98)

© PANHANDLE ENGINEERING, INC. ALL RIGHTS RESERVED. NO PART OF THIS DOCUMENT MAY BE REPRODUCED OR UTILIZED IN ANY FORM WITHOUT PRIOR WRITTEN AUTHORIZATION OF PANHANDLE ENGINEERING, INC.

PANHANDLE ENGINEERING, INC.
 ENVIRONMENTAL ENGINEERS • CIVIL ENGINEERS • LAND PLANNERS
 3005 South Highway 77 Lynn Haven, Florida 32444
 (850)763-5200 Fax (850)769-0730 panhandleengineering.com

EXHIBIT "A"-PLOT PLAN
CASA DEL MAR
TOWN HOME DEVELOPMENT
 PANAMA CITY BEACH, FLORIDA

CAD FILE: 78101-EX-1
DWN BY: CHM
DATE:
SHEET NO: 1 OF 1
PROJECT NUMBER 78101